

TRAY-PROOF

MINIMUM BATTERY WEIGHT : 165 Kg

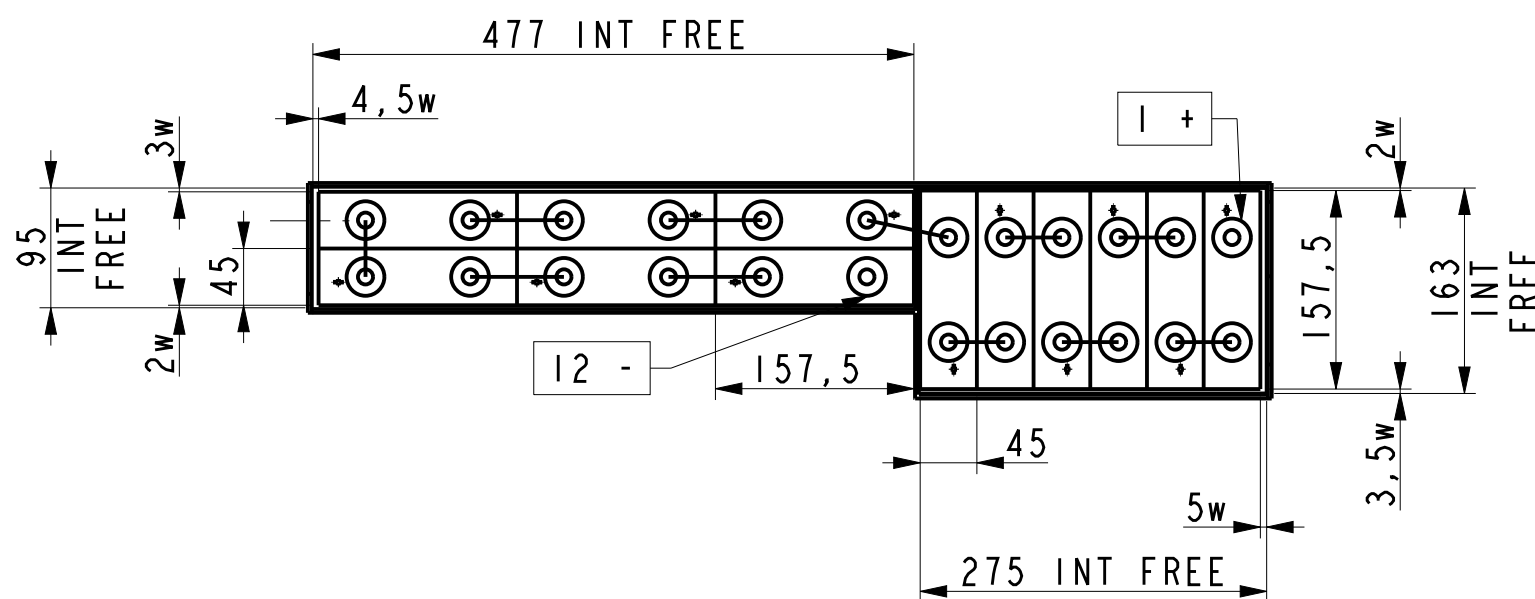

CRATE IN SHEET METAL Thk= 3 mm

The listing wedging reflects a thick coating of 1 mm.

	1	TRAY			32	
	1	BALLAST			0	
	1	TRAY + BALLAST + COATING	9935_50056_00		34	
	12	CELL: 2PZB_200			141	
	1	BATTERY			175	
REP	QTY	DESIGNATION	REFERENCE	MATERIAL	MASS	OBS

BATTERY 24V_2PZB_200
FENWICK-LINDE Type LI0/12 Type 379

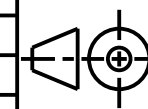

SCALE
1/6

INDICE
00



			DATE	INIT.	VISA	FORMAT	IDENTIFICATION NBR	N.FOLIO
			16/03/10	WJ	WJ			
00	Original	16/03/10	VERIFIED BY	16/03/10	GF	A3	9936_50056_00_A	1/1
IND	N.MODIF	DATE	These drawings are property of EnerSys and affiliated entities. All rights reserved.					