



LP MOTORCYCLE • AGM BATTERY

YTX5L-BS (12V 3Ah)

DIN: 50412

02/11/2020

Description

The motor battery YTX5L-BS, 12 volt, 4 Ah, is a starter battery with AGM technology. The YTX5L-BS is dry pre-charged and comes with a fitting acid pack. This lead-acid battery is, after filling and charging, 100% maintenance free and leak-proof. Can be installed in tilted position up to 45°. The YTX5L-BS is a real allrounder and suitable for seasonal use and short distances.

Performance

Rated Voltage	12
Nominal Capacity	4Ah (10hr)
CCA EN	50

Dimensions / Weight

Dimensions	Length	113 mm
	Width	70 mm
	Container Height	105 mm
	Total Height	105 mm
Net. Weight	1.67 Kg	
Weight acid	0.31 Kg	
Terminal	F	
Layout	0	

Features

- Absorbent Glass Mat technology
- Advanced starting power
- Excellent vibration resistant
- 100% maintenance free once activated



Layout

Terminal

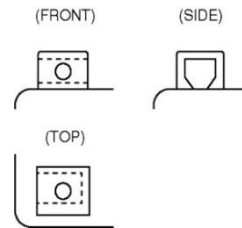

(Note) All above information shall be changed without prior notice, Landport Batteries reserves the right to explain and update the latest information.